

vtech®

Parent's Guide

Myla ⁺ *The Magical
Make-Up Unicorn* ⁺ ⁺ ⁺



91-003343-008 UK

VTech understands that a child's needs and abilities change as they grow and with that in mind we develop our toys to teach and entertain at just the right level...

vtech Baby

Toys that will stimulate their interest in different textures, sounds and colours

I am...

...responding to colours, sounds and textures

...understanding cause and effect

...learning to touch, reach, grasp, sit-up, crawl and toddle

Birth-36 months



Pre-School

Interactive toys to develop their imagination and encourage language development

I want...

...to get ready for school by starting to learn the alphabet and counting

...my learning to be as fun, easy and exciting as can be

...to show my creativity with drawing and music so my whole brain develops

3-6 years



Electronic Learning Computers

Cool, aspirational and inspiring computers for curriculum related learning

I need...

...challenging activities that can keep pace with my growing mind

...intelligent technology that adapts to my level of learning

...National Curriculum based content to support what I'm learning at school

4-10 years



To learn more about this and other VTech® products, visit www.vtech.co.uk

INTRODUCTION

Thank you for purchasing **VTech® Myla The Magical Make-Up Unicorn!** Hi! I'm Myla, welcome to the world of magic! Using my make-up brush, select any colour and apply it to my eyes, wings and horn to create unique styles! We can also play games, sing and have lots of fun together!

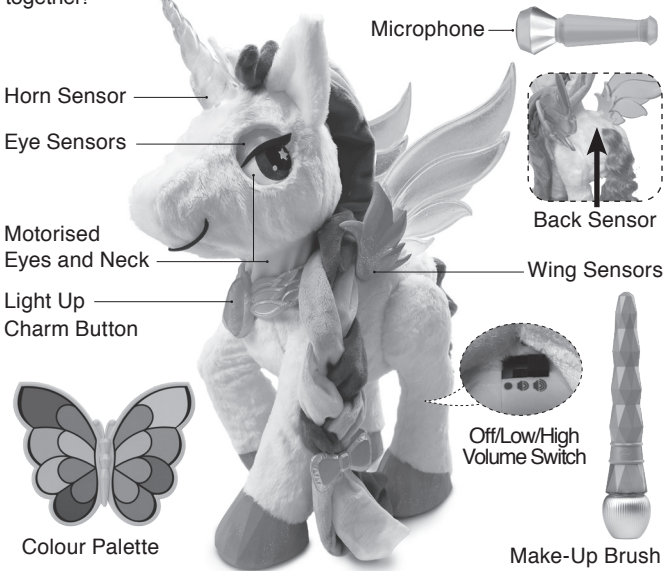

Bundled Accessories: Comb & Jewellery Play Pieces

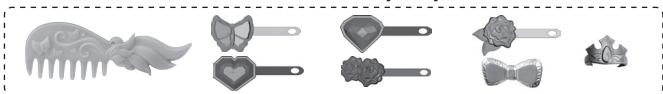

INCLUDED IN THIS PACKAGE

- One Myla The Magical Make-Up Unicorn
- One Make-Up Brush
- One Colour Palette
- One Microphone
- One Comb
- Seven Jewellery Play Pieces
- Parent's Guide

WARNING: All packing materials such as tape, plastic sheets, packaging locks, removable tags, cable ties and packaging screws are not part of this toy, and should be discarded for your child's safety.

NOTE: Please keep this parent's guide as it contains important information.

Unlock the packaging locks:

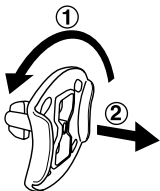

- ① Rotate the packaging locks 90 degrees anticlockwise.
- ② Pull out the packaging locks.

GETTING STARTED

BATTERY INSTALLATION (Unicorn)

1. Make sure the unit is turned **OFF**.
2. Locate the battery cover on the underside of the unit.
3. Install 4 new "AA" size (LR6/AM-3) batteries following the diagram inside the battery box. (The use of new alkaline batteries is recommended for maximum performance).
4. Replace the battery cover to secure it.

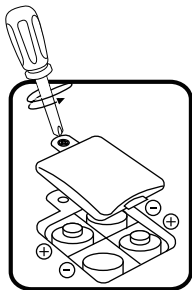

BATTERY INSTALLATION (Brush)

1. Make sure the unit is turned **OFF**.
2. Locate the battery cover of the unit.
3. Install 2 new “AAA” size (LR03/AM-4) batteries following the diagram inside the battery box. (The use of new alkaline batteries is recommended for maximum performance).
4. Replace the battery cover to secure it.

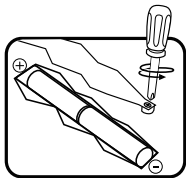

BATTERY NOTICE

- Alkaline Batteries are recommended.
- Use only batteries of the same or equivalent type as recommended.
- Do not mix different types of batteries: alkaline, standard (carbon-zinc) or rechargeable, or new and used batteries.
- Do not use damaged batteries.
- Insert batteries with the correct polarity.
- Do not short-circuit the battery terminals.
- Remove exhausted batteries from the toy.
- Remove batteries during long periods of non-use.
- Do not dispose of batteries in fire.
- Do not charge non-rechargeable batteries.
- Remove rechargeable batteries from the toy before charging (if removable).
- Rechargeable batteries are only to be charged under adult supervision.

Disposal of batteries and product



The crossed-out wheellie bin symbols on products and batteries, or on their respective packaging, indicates they must not be disposed of in domestic waste as they contain substances that can be damaging to the environment and human health.

The chemical symbols Hg, Cd or Pb, where marked, indicate that the battery contains more than the specified



value of mercury (Hg), cadmium (Cd) or lead (Pb) set out in Battery Directive (2006/66/EC).

The solid bar indicates that the product was placed on the market after 13th August, 2005.

Help protect the environment by disposing of your product or batteries responsibly.

For more information, please visit:

www.recycle-more.co.uk

www.recyclenow.com

PRODUCT FEATURES

1. OFF/LOW/HIGH VOLUME SWITCH

Slide the **OFF/LOW/HIGH VOLUME SWITCH** to either **LOW** or **HIGH** to turn the unit **ON**. To turn the unit **OFF**, slide the switch to **OFF**.

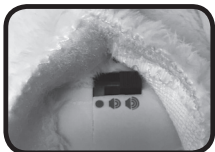

2. HORN SENSOR

Use the **MAKE-UP BRUSH** to choose a colour from the **Colour Palette** and point to the **HORN SENSOR** to see Myla's horn and mane light up.

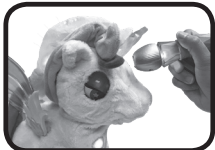

3. EYE SENSORS

Use the **MAKE-UP BRUSH** to choose a colour from the **Colour Palette** and point to both **EYE SENSORS** to see Myla's eyes light up.



4. WING SENSORS

Use the **MAKE-UP BRUSH** to choose a colour from the **Colour Palette** and point to both **WING SENSORS** to see Myla's wings light up.



5. LIGHT UP CHARM BUTTON

Press Myla's **LIGHT UP CHARM BUTTON** to choose different games and see the light flash.

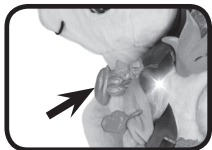

6. MAKE-UP BRUSH & COLOUR PALETTE

Use the **MAKE-UP BRUSH** to choose a colour from the **Colour Palette** and point to Myla's horn, eyes or wings to play. In order to recognise the colour successfully, make sure the transparent part of the **MAKE-UP BRUSH** is pressed down and covers the selected colour on the **Colour Palette** completely, until the brush lights up the colour you have selected.

If the **Colour Palette** gets dirty, please wipe it out with a soft cloth, otherwise the colours may not be recognised successfully.

To get the best recognition, we suggest playing indoors.

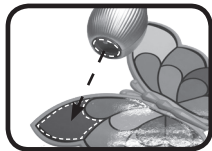

7. MICROPHONE

Put the **MICROPHONE** close to Myla's mouth to hear her sing.



8. MOTORISED EYES AND NECK

The **EYES AND NECK** will move as Myla talks.

9. BACK SENSOR

Touch Myla's back to hear sweet phrases and see light patterns.

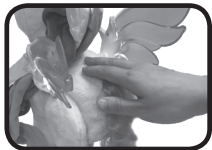

10. AUTOMATIC SHUT OFF

To preserve battery life, the unit will automatically shut off after several minutes without input. The **UNICORN** can be turned on again by pressing the **Light Up Charm Button**; the **MAKE-UP BRUSH** can light up again by pressing on the **colour palette** to choose a colour.

When the unit repeatedly powers down, please insert new batteries and try switching it on again.

ACTIVITIES

1. MAGICAL MAKE-UP GAME

Let's learn how to do some make-up with Myla! Use the **make-up brush** to choose a colour on the **colour palette** and put it on Myla's horn, eyes or wings.

2. MAGICAL COLOUR CREATION GAME

Let's create magical colours! Use the **make-up brush** to choose a colour on the **colour palette** and put it on Myla's horn, eyes or wings. Then, use the **make-up brush** to choose another colour and put it on the same horn, eye or wing.

3. LUCKY COLOUR GAME

Touch Myla's back, she will tell you your lucky colour!

4. AMAZING MAKE-UP POWDER GAME

Use the **make-up brush** to choose a colour on my **colour palette** and apply on me. Keep applying my make-up before the light goes out!

5. LET'S ROLL GAME

Press Myla's **Light Up Charm Button** to hear her sing. When she's singing, put your hand on her Back Sensor to add some light effects to her horn, mane, eyes and wings.

6. SING WITH ME GAME

Put the **microphone** close to Myla's mouth and sing with her by turns.

SONGS

SONG1:

Red and green and yellow too,
Orange, purple, pink and blue.
So many colours in this world,
That I can share with you!

SONG2:

We're going to shine and inspire the world.
With light and love for all the boys and girls.
It's the magical power of Myla the Unicorn!

SONG3:

Brush my tail.
Plait my hair.
Find a colour for my eyes to be.
What's your name,
I'm your friend,
Come along and play with me.

SONG4:

If you can dream it, then you can be it.
There's nothing that you can't do.
If you believe it, then you can see it.
Let's all celebrate with you!
Let's Go!

SONG5:

I love to sing won't you sing along.
It's lots of fun to sing, it's magic that you're bringing
To the world with a voice that's only yours.
Let's Sing!

CARE & MAINTENANCE

1. Keep the unit clean by wiping it with a slightly damp cloth.
2. Keep the unit out of direct sunlight and away from any direct heat source.
3. Remove the batteries when the unit is not in use for an extended period of time.

4. Do not drop the unit on hard surfaces and do not expose the unit to moisture or water.

TROUBLESHOOTING

If for some reason the unit stops working or malfunctions, please follow these steps:

1. Please turn the unit OFF.
2. Interrupt the power supply by removing the batteries.
3. Let the unit sit for a few minutes, then replace the batteries.
4. Turn the unit ON. The unit should now be ready to play with again.
5. If the unit still does not work, replace with an entire set of new batteries.

If the problem persists, please call our Consumer Services Department on 0330 678 0149 (from UK) or +44 330 678 0149 (outside UK) and a service representative will be happy to help you.

IMPORTANT NOTE:

Creating and developing **VTech®** products is accompanied by a responsibility that we at **VTech®** take very seriously. We make every effort to ensure the accuracy of the information which forms the value of our products. However, errors sometimes can occur. It is important for you to know that we stand behind our products and encourage you to call our Consumer Services Department on 0330 678 0149 (from UK) or +44 330 678 0149 (outside UK) with any problems and/or suggestions that you might have. A service representative will be happy to help you.

CLASS 1
LED PRODUCT



PRODUCT REGISTRATION

Visit www.vtech.co.uk/clubvtech/login
to register your VTech product

By joining the VTech Club you can also enter competitions, find out about news and events, seek expert advice for parents and let your kids play fun learning games and activities.



PRODUCT WARRANTY

Thank you for choosing this quality product from VTech. We hope it will bring many hours of entertainment, imaginative play and learning.

1. The product detailed above is covered by a one year warranty from the date of purchase, against any defects in materials or workmanship.
2. The product may be returned to the place of purchase. Alternatively the product can be returned to VTech Electronics Europe plc (see address below), with proof of purchase, without proof of purchase no replacement will be provided.
3. VTech Electronics Europe plc will examine the product and if it is found to be defective due to faulty materials or workmanship, will replace the product at their discretion.
4. If the product covered by this warranty is damaged due to misuse, modification or unauthorised repair, or because of faulty batteries, battery discharge or incorrect electrical connections, then this warranty becomes void.
5. This warranty is personal to the original purchaser and is not transferable.
6. Breakages to the LCD screen are not covered by the warranty.
7. Returns to VTech Electronics Europe plc should include a cheque or postal order for £1.50 towards the cost of return postage and packaging.
8. Products returned to VTech Electronics Europe plc, should be addressed as follows and packed carefully to avoid damage in transit (Please do not include batteries or adaptor). Please include details of the fault together with your name and address.
9. To keep an online record of your warranty, please register your product online at www.vtech.co.uk/warranty

Vtech Electronics EU PLC, c/o XPO Logistics, Warehouse 350, Cat & Fiddle Lane, West Hallam, DE7 6HE

THIS WARRANTY IS OFFERED AS AN EXTRA BENEFIT AND DOES NOT AFFECT CONSUMERS' STATUTORY RIGHTS.

This warranty is valid for the UK and Eire only. For products purchased outside the UK and Eire, please contact your local distributor or place of purchase.



**Visit our website for more
information about our products,
downloads, resources and more.**

www.vtech.co.uk



TM & © 2018 VTech Holdings Limited.

All rights reserved.

Printed in China.

91-003343-000 